

# BIATHLON NORTH AMERICAN CUP

---

21-22 JANUARY, 2012

**10th MOUNTAIN SKI CLUB  
FORT KENT, MAINE**

## INVITATION



## INVITATION

### A. General Information

#### A1. Competition Venue

10<sup>th</sup> Mountain Ski Center is located 2 km outside of Fort Kent  
Altitude of Stadium is 280 Meters above Sea level  
Altitude in Fort Kent is 170 meters above sea level

#### A2. Contact Information – 10<sup>th</sup> Mountain Center

10<sup>th</sup> Mountain Ski Center

Mailing Address:	P O Box 541 Fort Kent, ME 04743
Physical Address:	33 Paradis Circle Fort Kent, ME 04743
Web Site Address:	<a href="http://www.10thmtskiclub.org">www.10thmtskiclub.org</a>

#### A3. Contact Information Organizing Committee

Event Director  
Nancy Thibodeau  
10<sup>th</sup> Mt Ski Center  
P O Box 541  
Fort Kent, ME 04743  
Email: [nancyt@fairpoint.net](mailto:nancyt@fairpoint.net)  
Phone: 207-436-0003  
Fax: 207-834-6204

Competition Office:  
16-23 January, 2012  
10<sup>th</sup> Mt Ski Center Lodge, Upper  
Phone: 207-834-6203  
Email: [nancyt@fairpoint.net](mailto:nancyt@fairpoint.net)

Competition Chiefs:  
Chief of Competition: Jeff Dubis  
Chief of Stadium:  
Chief of Range:  
Chief of Timing:  
Chief of Course:

#### A4. Where to Report after Arrival

Teams should register in the main lodge by noon on Friday, 20 January, 2012 to confirm your participation numbers.  
Wax room assignments and keys may be picked up at the Competition office upon your arrival.

#### A5. Accreditation Office – Registration – Competition Office

Please report to the registration/competition office upon arrival to complete registration and receive further information about the event. Mail boxes will contain weather reports, start lists, results and other pertinent information. The Competition Office will be open from 0800 – 1700 hours from Monday, 16 January until Sunday 22 January. The Competition Office is located on the Upper level of the 10<sup>th</sup> Mountain Lodge.

#### A6. Liability/Insurance

The divisions/regions registering competitors shall be responsible for adequate insurance of participants. All participants must be appropriately insured against injuries, illness or possible damage of material. Neither the 10<sup>th</sup> Mountain Ski Center, Organizing Committee or Maine Winter Sports Center shall be liable for personal and material damage.  
Please sign the Release of Liability Statement on the registration form.



Biathlon North American Cup  
21 – 22 January 2012  
10<sup>th</sup> Mountain Ski Center, Fort Kent Maine

**A7. Regulations on Import/Export of Rifles and Ammunition and Radio Equipment and Medicine**

*Attached (Appendix is a letter of invitation to the USA for Biathlon Competitions this season. This is required with your submission for rifle permit applications. These applications should be submitted as soon as possible so that you have the paper work on hand for events this winter. Canadian citizens must apply for a permit for entry US Customs with a rifle. When crossing into the USA present the approved [ATF Form 6 NIA \(5330.3D\)](#) and the USBA Invitation to the customs officer. Information can be obtained by visiting:*

<http://www.atf.gov/forms/download/atf-f-5330-3d.pdf>

*Forms can be found in the appendix or at this web site:*

[www.atf.gov/forms/firearms/](http://www.atf.gov/forms/firearms/)

All Canadian team members should bring their FAC (rifle permit) with them.

For U. S. citizens crossing into Canada with rifles, stop at the American Customs office to register your rifle and then stop at the Canadian Customs office to purchase a rifle permit (CAD 50.00).

**A8. VISA Regulations**

**Passports will be needed at all border crossings.** If possible, athletes under the age of 18 should carry a permission letter from their parents to cross the border and to travel with coaches.

**B. Logistics**

**B1. Transportation – Directions to Venue**

**Driving Directions**

**i. From the North**

From Montreal (5.5 hours) or Quebec City (3 hours), take Trans Canada route number 20 (south shore route) east toward Riviere du Loup. Take exit #488, route 289 at St. Alexandre. About seven miles after the border of Quebec Province and New Brunswick (past the town of Baker Lake) turn right at the intersection of route 289 and route 120 to Clair, NB. There you will find the Canadian/US customs and border crossing. Take US highway 1 for one mile and then merge onto Maine highway #11 for one mile. There is a Blue and Yellow 10<sup>th</sup> Mountain Ski Center sign on the right, take a right onto Paradis Circle and another right onto the 10<sup>th</sup> Mt. road. The venue is one mile from Fort Kent.

**ii. From the South**

From Bangor (3.5 hours) take Interstate route 95 north until you come to exit number 264, Sherman, route 11. Follow Route 11 all the way to Fort Kent. The 10<sup>th</sup> Mt. venue is located about one mile before the town of Fort Kent. There will be a large blue 10<sup>th</sup> Mountain Ski Center sign on your left. Take a left onto Paradis Circle and follow the signs onto the 10<sup>th</sup> Mt. road.

**iii. From Presque Isle**

Take Route US route #1 to Caribou. In Caribou take route 161 to Fort Kent. In Fort Kent take route 11 South for one mile. There is a large blue 10<sup>th</sup> Mountain Ski Center sign on the right, take a right onto Paradis Circle and another right onto the 10<sup>th</sup> Mt. road. The venue is one mile from Fort Kent.

**Distances from Airports**

Presque Isle	1 hour	Quebec City	3 hours
Bangor	3.5 hours	Montreal	6 hours
Boston	7.5 hours	Fredericton	4 hours



Biathlon North American Cup  
21 – 22 January 2012  
10<sup>th</sup> Mountain Ski Center, Fort Kent Maine

Rental Vehicles:

Fort Kent: Pelletier Ford – 207-834-3173  
 Presque Isle: Northern Maine Regional Airport  
 Ace Rent A Car – 866-834-6709  
 Avis – 207-768-6761  
 Budget – 207-764-1397  
 E Z Auto Rental – 207-498-3494

**B2. Accommodations**

Divisions/regions will be responsible for their own accommodation arrangements. Please contact the hotels listed in the Appendix for your lodging. For your information, Clair, New Brunswick is right across the river/border and is virtually the same distance to the venue as the Fort Kent locations. Madawaska, Maine and Edmunston, New Brunswick are 25 miles east of Fort Kent. Accommodation listing – see Appendix C

**B3. Restaurants**

Check with the lodging management where you decide to stay. They can refer you to a local restaurant that will offer meals plans upon demand. A list of area restaurants is attached in Appendix D for your convenience.

**B4. Location of Meetings/Other Services**

OFFICE	LOCATION	16 January – 22 January
Competition Office and OC Office	10 <sup>th</sup> Mountain Lodge, Upper Level	0800-1700
Mail Boxes – Teams	10 <sup>th</sup> Mountain Lodge, Upper Level Landing	
Team Captain's Meeting	10 <sup>th</sup> Mountain Lodge, Main Level	1600 – 20 January
TD & Jury Office	Timing Complex - Venue	
Equipment Control	Timing Complex - Basement	15 minutes prior to official zero
Timing	Timing Complex - Venue	
Stadium Production	Timing Complex – Upper Level	
Flower Ceremony	Stadium	Immediate after competition
Press Office	10 <sup>th</sup> Mountain Lodge, Main Level	0800-1700 Competition Days Only



Biathlon North American Cup  
21 – 22 January 2012  
10<sup>th</sup> Mountain Ski Center, Fort Kent Maine

Competition Information

C1. Competition Program – A detailed program will be provided in the Team Captains Manual issued on registration

Date	Training/Zeroing	Competitions	Team Captains Meetings Other
Monday 16 Jan	0900 – 1200 Unofficial Training		Arrivals Range Available for team practice. OC office open 0800-1700
Tuesday 17 Jan			Arrivals Range Available for team practice. OC office open 0800-1700
Wednesday 18 Jan			Arrivals Range Available for team practice. OC office open 0800-1700
Thursday 19 Jan	0900 – 1200 Unofficial Training		
Friday 20 Jan	0900 – 1200 Official Training – All Classes		1600 Team Captains Meeting, 10 <sup>th</sup> Mt Lodge
Saturday 21 Jan	0900 Zeroing – All Classes  1300 Citizen Biathlon Rifle Safety Instruction	1000 Sprint  1400 Maine Biathlon Championship	
Sunday 22 Jan	0900 Zeroing – All Classes	1000 Mass Start	

C2. Competition Regulations/Types/Classes



# Biathlon North American Cup

21 – 22 January 2012

10<sup>th</sup> Mountain Ski Center, Fort Kent Maine

## NORAM RECOGNIZES THE FOLLOWING CLASSES:

Men, Women, Junior Men, Junior Women, Youth Men and Youth Women

CLASS	AGE	Sprint	Mass Start
<b>Men</b>	<b>21 +</b>	10 km PS 3.3kmX3	15 km PPSS 3kmX5
<b>Women</b>	<b>21 +</b>	7.5 km PS 2.5kmX3	12.5 km PPSS 2.5X5
<b>Junior Men</b>	<b>19/20</b>	10 km PS 3.3kmX3	12.5 km PPSS 2.5X5
<b>Junior Women</b>	<b>19/20</b>	7.5 km PS 2.5kmX3	10 km PPSS 2kmX5
<b>Youth Men</b>	<b>17/18</b>	7.5 km PS 2.5kmX3	10 km PPSS 2kmX5
<b>Youth Women</b>	<b>17/18</b>	6 km PS 2kmX3	7.5 km PPSS 1.5kmX5
<b>Masters Men</b>	<b>30-39</b>	7.5 km PS 2.5kmX3	12.5 km PPSS 2.5kmX5
<b>Senior Masters Men</b>	<b>40-49</b>	7.5 km PS 2.5kmX3	12.5 km PPSS 2.5kmX5
<b>Veterans Master Men</b>	<b>50+</b>	7.5 km PS 2.5kmX3	12.5 km PPSS 2.5kmX5
<b>Masters Women</b>	<b>30-39</b>	6 km PS 2kmX3	7.5 km PPSS 1.5kmX5
<b>Senior Masters Women</b>	<b>40-49</b>	6 km PS 2kmX3	7.5km PPSS 1.5kmX5
<b>Veteran Master Women</b>	<b>50+</b>	6km PS 2kmX3	7.5km PPSS 1.5kmX5
<b>Senior Boys</b>	<b>15/16</b>	6km PS 2km X3	7.5km PPSS 1.5kmX5
<b>Senior Girls</b>	<b>15/16</b>	6km PS 2kmX3	7.5km PPSS 1.5X5

\*\* Athletes who wish to compete out of age class must receive an exemption by following the Hosting Policies Application to Ski Out Of Age Class At North American Cups. This application must be submitted no later than 14 days prior to the event. Please contact your coach for application completion.

### C3. Eligibility/Participation/Registration/Entries



# Biathlon North American Cup

21 – 22 January 2012

10<sup>th</sup> Mountain Ski Center, Fort Kent Maine

If correctly registered and entered by their Canadian Division or USBA Region any member of USBA or Biathlon Canada in good standing may participate in this event if they have a valid USBA or Biathlon Canada Competitor membership card. The competitors must be prepared to show their membership card for the current year at the event registration. It is mandatory that all athletes have in their possession and be able to show upon request their governing nations/ required rifle possession permit.

The OC will follow the Hosting Policy for Biathlon North America regarding citizenship and residency.

No quota for participation is set for this NorAm.

Registration of this event may be made by the Region or Divisions or by the individual competitors.

## C4. IBU Representatives/Officials

TD:

IR Range:

IR Start/Finish:

IR Course

## C5. Targets

The range has 30 lanes with electronic targets.

## C6. Course

The OC does NOT plan to use Sodeberg Summit (large climb) trail for this event.

## C7. Waxing Rooms

Waxing rooms will be assigned prior to your arrival and the key may be picked up from the registration table/competition office. A \$20.00 refundable key deposit will be collected on registration. There are restroom facilities in the wax complex that the athletes and teams may use.

## C8. Special Regulations

The IBU Event and Competition Rules will be in effect for this event, except as specifically modified by the North American Hosting Policies.

## C9. Entry Deadlines

All entries must be received 14 days prior to start of the competition, **7 January 2012**. Appendix A contains the entry form.

	ENTRY FEE STRUCTURE NACH/U.S. NATIONALS	
	All IBU CLASSES U.S. Funds	
	Before 7 January	8 January to event
One (1) competition	USD 40	USD 45
Two (2) competitions	USD 55	USD 60

## C9. Stadium and Course Maps – go to [www.10thmtskiclub.org](http://www.10thmtskiclub.org)

\*\*The OC does NOT plan to use Sodeberg Summit (large climb) trail for this event.



## Appendix

- A. Entry Forms
- B. Stadium & Course Maps are available at  
[www.10thmtskiclub.org](http://www.10thmtskiclub.org)
- C. Accommodation Listing
- D. Restaurant Listing



Biathlon North American Cup  
21 – 22 January 2012  
10<sup>th</sup> Mountain Ski Center, Fort Kent Maine

**INDIVIDUAL ENTRY FORM**

Last Name: \_\_\_\_\_ First Name: \_\_\_\_\_

Address: \_\_\_\_\_ City: \_\_\_\_\_ State/Prov: \_\_\_\_\_ Zip: \_\_\_\_\_

Email: \_\_\_\_\_ Phone: \_\_\_\_\_

Date of Birth: \_\_\_\_/\_\_\_\_/\_\_\_\_ Age: \_\_\_\_\_

USBA or Biathlon Canada #: \_\_\_\_\_ Club or Team: \_\_\_\_\_

Emergency Contact Name: \_\_\_\_\_ Emergency Contact Telephone #: \_\_\_\_\_

In Fort Kent – Name of Accommodation Provider: \_\_\_\_\_

**COMPETITION INFORMATION –**

Class - Please circle applicable category.			Event	FEE before 7 Jan	After 7 Jan
Senior Men	Senior Women	Master Men	ALL	Two: \$55	Two \$60
Junior Men	Junior Women	Master SM	Sprint	One \$40	One \$45
Youth Men	Youth Women	Master VM			
Senior Boys	Senior Girls	MasterWomen	Mass Start		
		Master SW			
		Master VW			
Total Payment Due					

**WAIVER AND RELEASE OF LIABILITY**

*Identification of risk.* I, the above named competitor, know that biathlon consisting of Nordic skiing and rifle marksmanship, involves risks of serious injury, including permanent disability and death. I understand that these injuries might result not only from my actions, but the actions or negligence of others.

*Assumption of Risk.* I agree that I am responsible for my safety while participating in biathlon training and completion. I assume all risks, both known and unknown, connected with my participation.

*Waiver.* Being aware of the risks and willing to assume them, I waive, release and hold harmless 10<sup>th</sup> Mountain Ski Club and Maine Winter Sports Center, volunteers, directors, officers, coaches, sponsors, advertisers, and owners/leasers of used premises from all claims for liability, injury, loss, or damage connected with my participation in biathlon training and competition. I intend for this waiver and release to also apply to my relatives, personal representatives, heirs, beneficiaries, next of kin and assigns.

*Insurance.* I currently have, and agree to maintain through the time I participate, sufficient medical and accident insurance. I understand that this is my responsibility and release anyone from providing it for me.

I have read this agreement carefully, understand that I give up substantial rights by signing it and sign it voluntarily.

Participant's Signature \_\_\_\_\_ Date \_\_\_\_\_

**FOR PARTICIPANTS UNDER AGE 18:** In consent to the above person's participation in biathlon training and competitions. I acknowledge that I assume all risks, know and unknown, and waive all claims in advance.

Parent/Guardian's Signature \_\_\_\_\_ Date \_\_\_\_\_

Registration with Payment **Due 8 January 2012.** Please enclose payment with registration form.

Mail to: 10<sup>th</sup> Mountain Ski Club, P O Box 541, Fort Kent, ME 04743 or

Fax to: 207-834-6204 or Email to: [nancyt@fairpoint.net](mailto:nancyt@fairpoint.net)





Biathlon North American Cup  
 21 – 22 January 2012  
 10<sup>th</sup> Mountain Ski Center, Fort Kent Maine

Stadium & Course Maps:

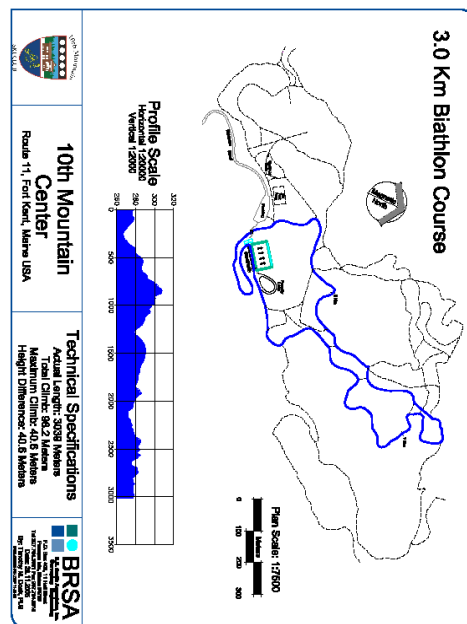
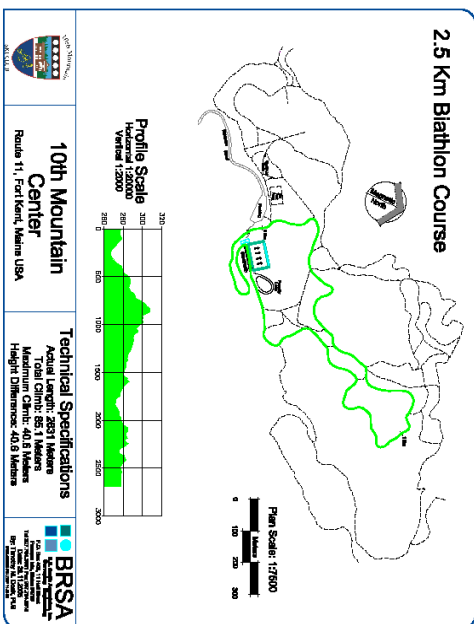
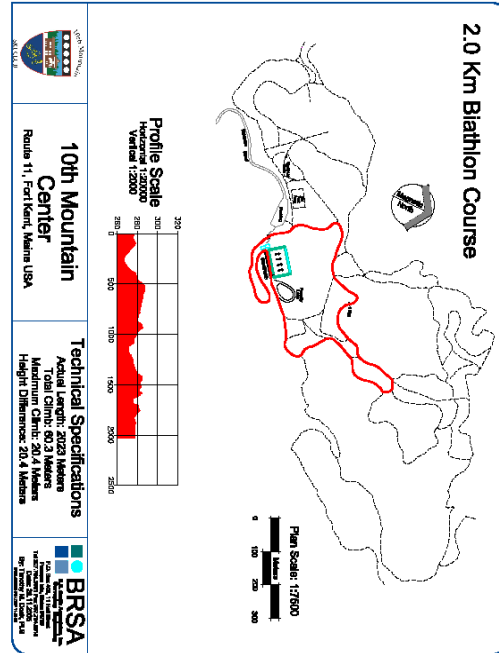
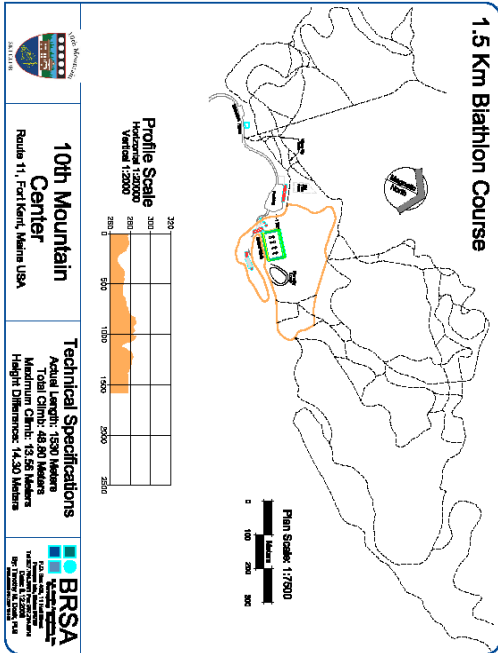

Biathlon North American Cup  
 21 – 22 January 2012  
 10th Mountain Ski Center, Fort Kent Maine

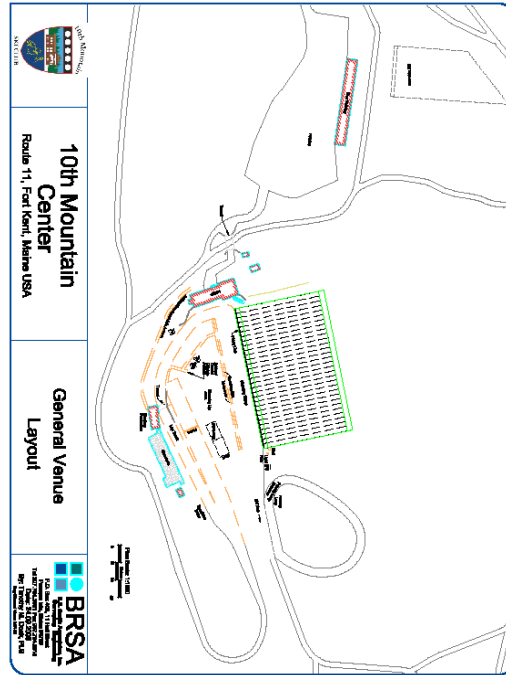
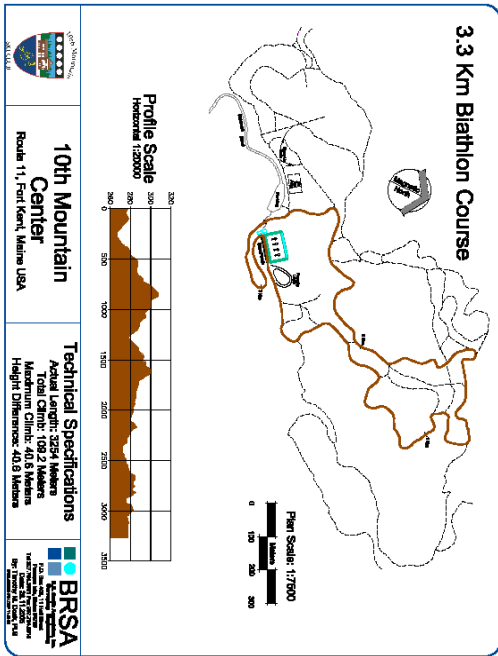

Biathlon North American Cup  
21 – 22 January 2012  
10<sup>th</sup> Mountain Ski Center, Fort Kent Maine

Accommodation Listing - Greater Fort Kent Area				
Company Name	Miles From Venue	Location Address	City	Phone
Bouchard Family Farm & Cabins on Eagle Lake	12	3 Strip Rd	Eagle Lake	207-834-3237
Fish River Lodge	15	316 Old Main St	Eagle Lake	207-444-5207
Four Seasons Inn	10	13 Church Street	Soldier Pond	207-834-4722
Highland Vacation Rentals	2	Highland Ave	Fort Kent	860-429-3869
Lakeside Lodge on Long Lake	20	246 Sinclair Rd, Route 162	Sinclair	207-543-7517
Long Lake Motor Inn	15	596 Main St	St Agatha	207-543-5006
Lugdon Lodge, LLC	12	1695 Sly Brook Rd	Eagle Lake	207-444-4557
Maple Leaf	2	795 Rue Principal	Clair	506-992-2120
Northern Door Inn	2	356 West Main St	Fort Kent	207-834-3133
Overlook Motel & Lakeside Cabins	12	3232 Aroostook Rd	Eagle Lake	207-444-4535
P & R Adventure	15	Eagle Lake	Eagle Lake	207-783-3244
Picture Perfect Cottages & Snowshoes	12	Rt. 11	Eagle Lake	207-834-4510
Rilester River Camps	10	561 Sly Brook Rd	Wallagrass	207-444-6501
Track Down Cabins & Lodge	1	891 Aroostook Rd, Route 11	Wallagrass	207-834-3612
Camel Brook Camps	5	447 Violate Settlement	Fort Kent	207-834-6324
Cedar Lane Getaway	15	141 Cedar Lane	Eagle Lake	207-444-4506
Cozy Cottage Get Away	15	2495 Aroostook Rd	Eagle Lake	207-444-5279
Cross Roads Cabins	2	Cross Road	Fort Kent	207-834-6717
Pond Brook Cabins	20		Eagle Lake	207-444-6108



Biathlon North American Cup  
21 – 22 January 2012  
10<sup>th</sup> Mountain Ski Center, Fort Kent Maine

## Restaurant Listing

Restaurant Listing Fort Kent Area						
Al's Tastee Freeze	16 Hall Street	Fort Kent	ME	04743	Al Bouchard	834-5324
Armark Services University of Maine Fort Kent	23 University Dr	Fort Kent	ME	04743	Jason Carter	834-7500
China Garden	PO Box 67	Fort Kent	ME	04743	Tina Geel	834-2045
Custom Cafe	Main St	Fort Kent	ME	04743		834-1140
Doris Café	PO Box 144	Fort Kent Mills	ME	04744	Linda Daigle Marquis	834-3017
Fort Kent Subway	137 Bennett Drive	Caribou	ME	47436	Mark Carey	493-6689
Lakeview Restaurant	9 Lakeview Dr	St Agatha	ME	04772	Jenn Daigle	543-6331
Maple Leaf Queen's Buffet	795 Rue Principal	Clair	NB	E7A 2H5	Michel Soucy	506-992-2120
McDonald's Restaurant	77 East Main St	Fort Kent	ME	04743	Angie Gagnon	834-7330
Rocks Family Diner	378 West Main St	Fort Kent	ME	04743	Peter Pinette	834-2888
Swamp Buck Restaurant	250 West Main St	Fort Kent	ME	04743	Mark Tardif	834-3055
Track Down Lodge and Cabins	891 Aroostook Rd	Wallagrass	ME	04781	Joel Guimond	834-3621

